



**HIGH
RATE
MAX^{XT}**



UPS12-700MRX

Valve Regulated Lead Acid Battery

Designed for UPS Standby Power Applications

FEATURES AND BENEFITS

APPLICATIONS

- Data Centers
- Network Operation Centers
- Industrial Process Control Facilities
- Internet Housing Sites
- Semiconductor Manufacturing
- Banks and Financial Markets
- Power Generation Plants
- Hospital and Testing Laboratories
- Emergency Response Center

- 12 year design life @ 25°C
- Eurobat classification: Long life
- Absorbent Glass Mat (AGM) technology for efficient gas recombination of up to 99% and freedom from electrolyte maintenance
- C&D's Long-Life Alloy having very low calcium levels in the industry -minimizing grid growth, reducing gassing, and extending battery life
- UL Recognized Flame-arresting vents in each cell for safety and long life
- Designed with the same recombination, thermal runaway prevention, gassing and flame-retardant characteristics of the Bellcore 4228 compliant Dynasty Telecom products
- Flame retardant polypropylene case and cover compliant with UL94 V-0
- Proprietary Fixed Orifice Plate Pasting technology applying active materials on both sides of the grid for consistent cell-to-cell performance, higher capacity and uniform grid protection
- Thermally welded case-to-cover bond to eliminate leakage
- Front Access Design, for easy installation and safety maintenance, and space saving
- Not restricted for air transport -Complies with IATA/ICAO Special Provisions A67
- Not restricted for surface transport - Classified as non-hazardous material as related to DOT-CFR Title 49 parts 171-189
- Not restricted for water transport -Classified as non-hazardous material per IMDG Amendment 27

V 0920-MRX-E

Specifications

Cells per Unit	Voltage	Weight	15min WPC@ 1.67EPV	Capacity (C20,1.75V,25°C)	Capacity (C10,1.80V,25°C)	IEC Rating (C10,1.80V, 20°C)	IEC Short Circuit Current	IEC Resistance
6	12V	66 Kg	700 W/cell	228 Ah	211 Ah	204 Ah	5150 Amps	2.8 (mΩ)

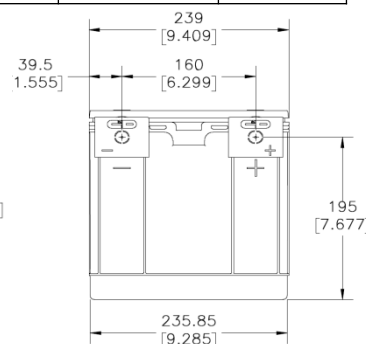
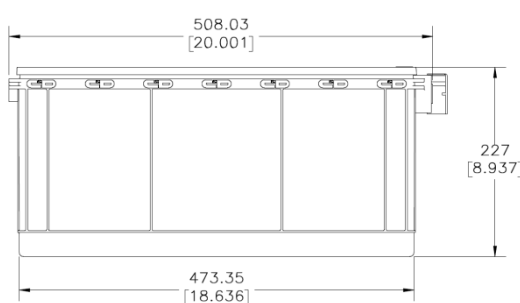
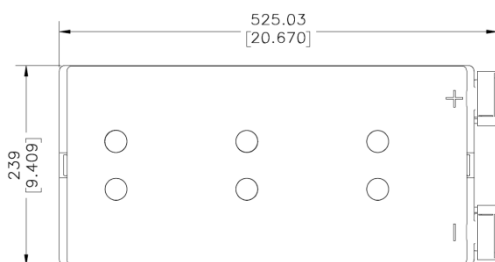

*All dimensions in millimeters and (inches). All dimensions are for reference only. Contact a C&D Representative for complete dimensional information.

Specifications

Operating Temperature Range with temperature compensation	Discharge: -40°F (-40°C) to +160°F (71°C) Charge: -10°F (-23°C) to +140°F (60°C)
Nominal Operating Temperature Range	+74°F (23°C) to +80°F (27°C)
Recommended Maximum Charging Current Limit	C/5 amperes @ 20hr rate
Float Charging Voltage	13.65 ± 0.15 VDC average per 12V unit
Maximum AC Ripple (Charger)	0.5% RMS or 1.5% P-P of float charge voltage recommended for best results. Max voltage allowed = 1.4% RMS (4% P-P), Max current allowed = C/20 A RMS
Self Discharge	Battery can be stored up to 4 months at 77°F (25°C) before a freshening charge is required. Batteries stored at temperatures greater than 77°F (25°C) will require recharge sooner than batteries stored at lower temperatures. See C&D brochure 41-7272, Self-Discharge and Inventory Control for details.
Equalize charge and cycle service voltage	14.40 to 14.80 VDC average per 12V unit @ 77°F (25°C)
Terminal	Threaded copper alloy insert terminal to accept M8 bolt
Terminal Hardware Initial Torque	160 in.-lbs. (18 N-m)

Constant Power Discharge Table - Watts Per Cell @ 25°C (77°F)

Operating Time to End Point Voltage

EPV	5 min	10 min	15 min	20 min	25 min	26 min	30 min	45 min	60 min	90 min	2 hr	3 hr	4 hr	5 hr	8 hr	10 hr	12 hr	20 hr
1.85	737.8	690.8	595.4	503.3	434.9	426.8	391.4	308.2	260.2	192.9	155.9	111.9	87.7	72.6	48.7	40.3	34.6	22.0
1.80	963.4	780.5	651.2	548.1	471.9	462.9	423.5	329.1	275.1	203.3	164.0	117.4	91.8	75.8	50.7	41.9	35.9	22.7
1.75	1062.9	824.0	676.2	568.2	488.5	479.0	437.9	338.5	281.9	206.9	166.2	119.1	93.2	76.8	51.6	42.7	36.5	23.2
1.70	1120.1	853.9	692.5	582.1	500.5	490.9	448.8	344.4	285.3	209.5	168.2	120.3	94.0	77.7	52.1	43.1	36.9	23.4
1.67	1138.4	866.3	700.0	588.0	505.3	495.5	452.9	346.3	286.2	210.3	168.9	120.8	94.4	78.0	52.2	43.1	36.9	23.4
1.65	1151.2	874.4	707.2	592.8	508.6	498.6	455.3	348.3	288.0	211.2	169.5	121.1	94.6	78.2	52.3	43.2	36.9	23.4

Constant Current Discharge Table - Amps @ 25°C (77°F)

Operating Time to End Point Voltage

EPV	5 min	10 min	15 min	30 min	60 min	90 min	2 hr	3 hr	4 hr	5 hr	6 hr	7 hr	8 hr	10 hr	12 hr	20 hr	24 hr
1.90	254.3	254.3	250.7	176.3	117.6	85.7	68.5	50.4	40.5	33.6	28.8	25.3	22.5	18.5	15.7	9.9	8.3
1.85	380.5	364.9	301.2	198.7	132.6	96.8	77.4	55.7	44.7	37.0	31.6	27.7	24.6	20.2	17.1	10.7	9.1
1.80	506.6	437.7	342.8	220.5	141.0	102.2	81.3	58.9	47.1	38.8	33.2	29.0	25.8	21.1	17.9	11.2	9.4
1.75	586.4	461.5	359.1	225.6	144.9	104.4	82.7	60.2	48.1	39.6	33.9	29.6	26.3	21.5	18.3	11.4	9.6

Note: Batteries to be mounted with 0.5 in. (1.25 cm) spacing minimum and free air ventilation. Specifications subject to change without notification.